

© Wildblood Macdonald Architects Ltd. All rights reserved. No part of this document may be reproduced, stored in a retrieval system, or transmitted in any form or by any means, electronic, mechanical, photocopying, recording, or by any information storage and retrieval system, without the prior written permission of Wildblood Macdonald Architects Ltd.

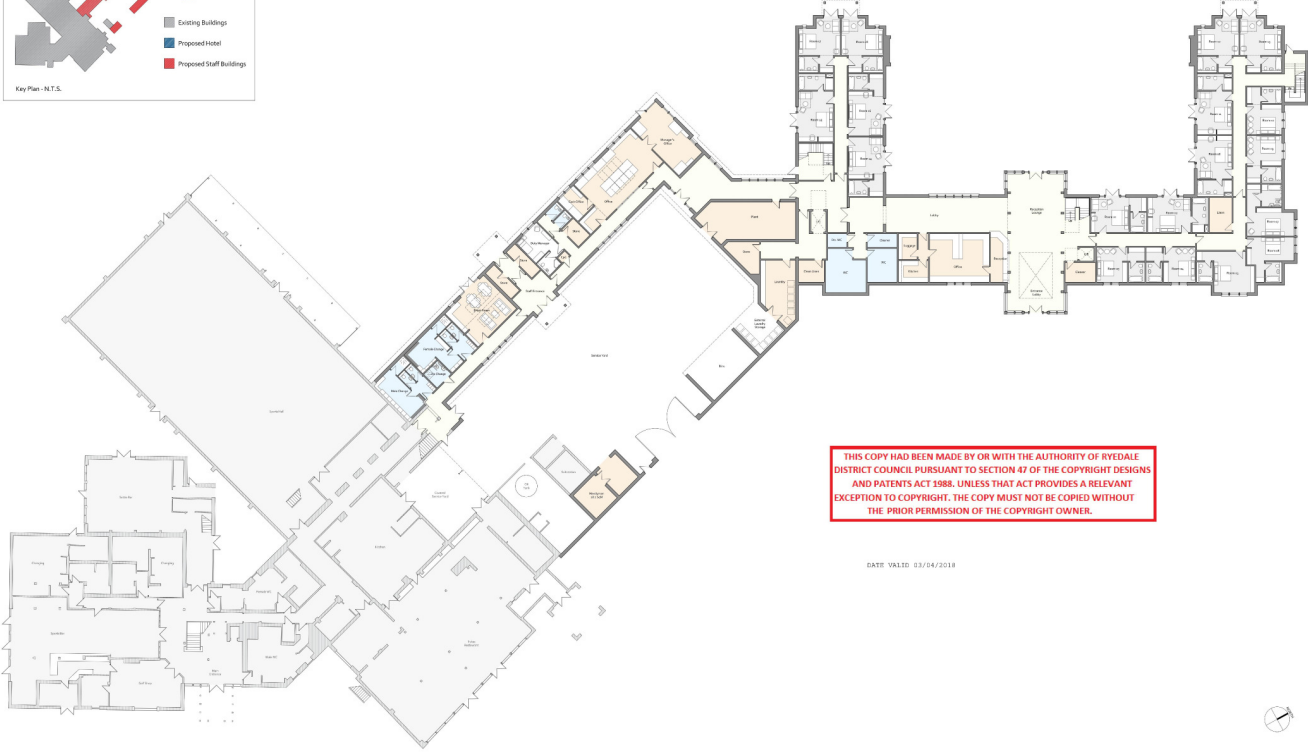

THIS COPY HAD BEEN MADE BY OR WITH THE AUTHORITY OF RYEDALE DISTRICT COUNCIL PURSUANT TO SECTION 47 OF THE COPYRIGHT DESIGNS AND PATENTS ACT 1988. UNLESS THAT ACT PROVIDES A RELEVANT EXCEPTION TO COPYRIGHT, THE COPY MUST NOT BE COPIED WITHOUT THE PRIOR PERMISSION OF THE COPYRIGHT OWNER.

DATE VALID: 03/04/2018



Rev.	Description	By	Date
1	Floor Plans Update for Planning	RI	01/08/18
2	Floor Plans Update	RI	06/08/18
3	Final Floor Plans	RI	06/08/18
4	Final Floor Plans	RI	06/08/18
5	Final Floor Plans	RI	06/08/18
6	Final Floor Plans	RI	06/08/18
7	Final Floor Plans	RI	06/08/18
8	Final Floor Plans	RI	06/08/18
9	Final Floor Plans	RI	06/08/18
10	Final Floor Plans	RI	06/08/18

wildblood macdonald
 Parkhill Studio, Parkhill, Nelson Road
 Wakefield, LS2 3PZ
 01924 202020 Fax 01924 202021
 www.wildblood-macdonald.com

Client: Sandburn York Ltd.
 Project: New Hotel & Staff Accommodation Sandburn Hall Flaxton
 Drawing Title: Proposed Ground Floor Plan
 Scale: 1:200 @ A4
 Date: 24.01.18
 Drawn: F
 Checked: RI
 Date: 03/04/2018
 Discipline: PLANNING
 Status: RI